

Q

Search UniFi products

Kits > [G3 Starter Kit](#)

Datasheet

In The Box

Marketing Images

Installation Guide

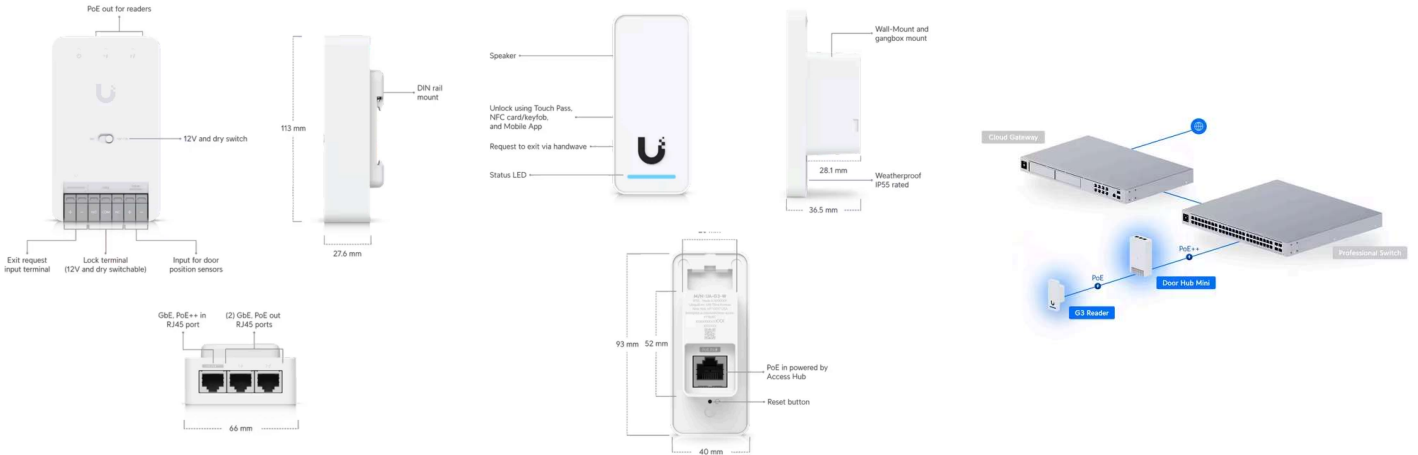

Overview

In the Box

- (1) Door Hub Mini
- (1) G3 Reader
- (2) Pocket Keyfobs

Touch Pass

10 free 1-year Touch Passes included  
[Learn More](#)

Door Hub Mini

Dimensions

113 x 66 x 27.6 mm  
(4.4 x 2.6 x 1.1")

Supported Doors

1

Input Terminals	(1) Door Exit Request (1) Door Position
Power Method	PoE++ UL 294 Power-limited Class 2 PSU UL 60950-1/62368-1 LPS/PS2 PSU
NDAA Compliant	✓
UL 294 Level	Destructive attack: Level I Line security: Level I Endurance: Level I Standby power: Level I
Weight	190 g (6.7 oz)
Enclosure Material	Polycarbonate, metal
Mounting	DIN-rail (Included)
Ambient Operating Temperature	0 to 40° C (32 to 104° F)
Ambient Operating Humidity	5 to 90% noncondensing
Networking Interface	(3) GbE RJ45 ports
PoE Interface	(1) PoE++ input, 50V DC, 1A (2) PoE outputs, total 31W
Max. Power Consumption	19W (Without PoE output) 50W (With PoE output)
Digital Input	Request to exit, door position sensor
Dry Output Relay	30V DC, 1A
Wet Output Relay	12V DC, 1A
LEDs	B/W <a href="#">Learn More</a>
Button	(1) Factory-reset (1) Dry/Wet switch
Recommend Max. Cable Length	
UA-Lock-Electric (400mA)	24 AWG length: 25 m (82 ft) 22 AWG length: 42 m (138 ft) 20 AWG length: 66 m (217 ft) 18 UACC-Cable-DoorLockRelay length: 100 m (328 ft)
	24 AWG length: 12 m (29 ft) 22 AWG length: 20 m (66 ft)

UA-Lock-Magnetic-540kg (500mA)	20 AWG length: 30 m (98 ft) 18 UACC-Cable-DoorLockRelay length: 46 m (262 ft)
UA-Lock-Magnetic-270kg (800mA)	24 AWG length: 12 m (29 ft) 22 AWG length: 20 m (98 ft) 20 AWG length: 30 m (167 ft) 18 UACC-Cable-DoorLockRelay length: 46 m (151 ft)
Other locks (1A)	24 AWG length: 9 m (30 ft) 22 AWG length: 15 m (49 ft) 20 AWG length: 24 m (79 ft) 18 UACC-Cable-DoorLockRelay length: 36 m (118 ft)
PoE Cabling Requirements	<p>Cat 5e cabling is the minimum performance category recommended. The performance category utilized should match the transmission speed required at the installation site.</p> <p>The minimal conductor gauge permitted to connect between the PSE or power injector and the PD shall be 26 AWG (0.13 mm<sup>2</sup> ) for patch cords; 24 AWG (0.21 mm<sup>2</sup> ) for horizontal or riser cable.</p>
UL 294 Statement	<p>Compliance with IEEE 802.3 specifications was not verified as part of UL 294.</p> <p>The equipment is intended to comply with the section of the National Electrical Code, ANSI/NFPA 70, Article 725.121, Power Sources for Class 2 and Class 3 Circuits.</p>
CAN/ULC-60839-11-1 Grade	Grade assignment: I
Certifications	CE, FCC, IC, UL 294, CAN/ULC-60839-11-1
Document number, and issue date and/or revision level	UA-Hub-Door-Mini, V01
Software Information	The software version can be checked at <a href="https://unifi.ui.com">https://unifi.ui.com</a>
<b>^ G3 Reader</b>	
Dimensions	93 x 40 x 36.5 mm (3.7 x 1.6 x 1.4")
NFC Card & Keyfob Access	✓
Apple/Google Wallet	✓
Mobile Unlock	✓
Handwave Request to Exit	✓
Weatherproofing	IP55
NDAA Compliant	✓

UL 294 Level	Destructive attack: Level I Line security: Level I Endurance: Level I Standby power: Level I
Weight	82 g (2.9 oz)
Enclosure Material	Polycarbonate, glass
Mount Material	Aluminum alloy
Mounting	In-wall, gang box (Included) Junction box (Optional)
Indoor and Outdoor Use	✓
Ambient Operating Temperature	-30 to 45° C (-22 to 113° F)
Ambient Operating Humidity	5 to 90% noncondensing
Networking Interface	(1) 10/100 MbE RJ45 port
Connectivity	BLE 4.1 NFC
Power Method	PoE UL 294 Power-limited Class 2 PSU UL 60950-1/62368-1 LPS/PS2 PSU
Max. Power Consumption	5W
Supported Voltage Range	48V DC
ESD/EMP Protection	Air: ±15kV, contact: ±8kV
Sensors	Proximity sensor
Speaker	(1) Yes, 0.7W
LEDs	R/G/B/W <a href="#">Learn More</a>
Button	(1) Factory-reset
NFC Frequency	13.56 MHz
NFC Read Range	< 30 mm (1.18")
NFC Technology	ISO/IEC 14443A / 14443B / 15693 / 18092 (Ecma 340) MIFARE Classic / MIFARE DESFIRE Sony FeliCa™ (ID only) NFC Forum tags T1T, T2T, T3T, T4T and T5T ECP 2.0

PoE Cabling Requirements	<p>Cat 5e cabling is the minimum performance category recommended. The performance category utilized should match the transmission speed required at the installation site.</p> <p>The minimal conductor gauge permitted to connect between the PSE or power injector and the PD shall be 26 AWG (0.13 mm<sup>2</sup> ) for patch cords; 24 AWG (0.21 mm<sup>2</sup> ) for horizontal or riser cable.</p> <p>Compliance with IEEE 802.3 specifications was not verified as part of UL 294.</p>
UL 294 Statement	The equipment is intended to comply with the section of the National Electrical Code, ANSI/NFPA 70, Article 725.121, Power Sources for Class 2 and Class 3 Circuits.
CAN/ULC-60839-11-1 Grade	Grade assignment: I
Certifications	CE, FCC, IC, UL 294, CAN/ULC-60839-11-1
Document number, and issue date and/or revision level	UA-G3, V01
Software Information	The software version can be checked at <a href="https://unifi.ui.com">https://unifi.ui.com</a>
<b>^ Pocket Keyfob</b>	
Dimensions	84 x 39 x 7.4 mm (3.3 x 1.5 x 0.29")
Weight	16 g (0.56 oz)
Enclosure Material	Polycarbonate, stainless steel, silicone rubber
Weatherproofing	IP54
NDAA Compliant	✓
Ambient Operating Humidity	10 to 90% noncondensing
Ambient Operating Temperature	-10 to 45° C (14 to 113° F)
NFC Frequency	13.56 MHz
NFC Technology	ISO/IEC 14443 Type A MIFARE DESFire EV3 4K UniFi Access Proprietary Security Protocol
Certification	CE

### Stay in Touch

Email



Subscribe



[Terms of Service](#) | [Privacy Policy](#) | [Legal](#) | [Cookies Settings](#)

© 2025 Ubiquiti, Inc. All rights reserved.