

Search UniFi products

Switching   WiFi   Camera Security   Door Access   Integrations   Advanced Hosting

Readers > [G3 Reader](#)

Datasheet   In The Box   Marketing Images   Installation Guide

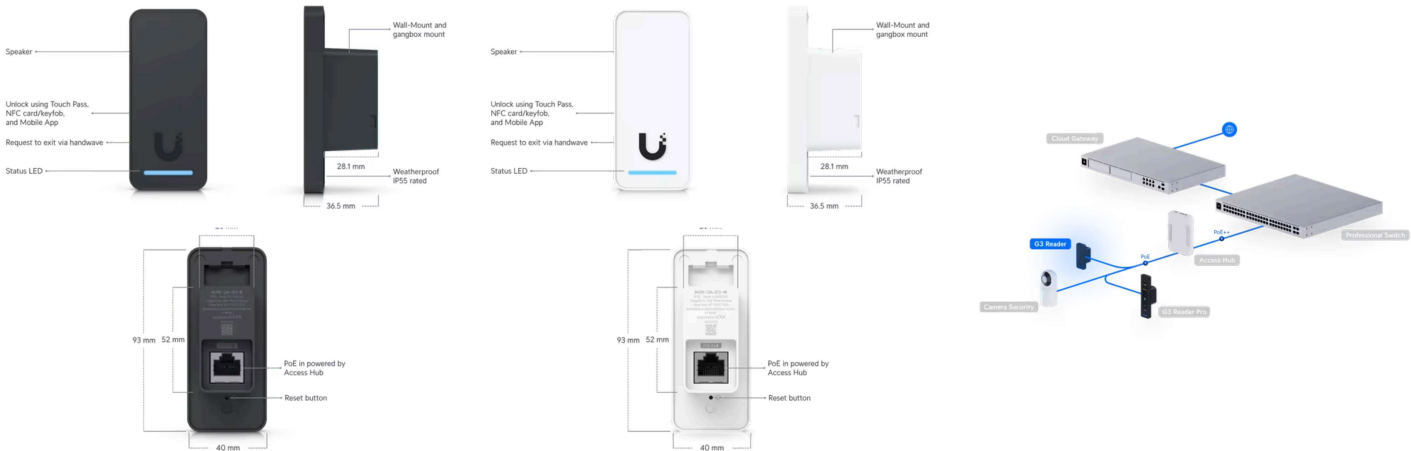

Overview

Dimensions	93 x 40 x 36.5 mm (3.7 x 1.6 x 1.4")
NFC Card & Keyfob Access	✓
Apple/Google Wallet	✓
Mobile Unlock	✓
Handwave Request to Exit	✓
NDAA Compliant	✓
UL 294 Level	Destructive attack: Level I Line security: Level I

Endurance: Level I  
Standby power: Level I

Weatherproofing IP55

^ **Mechanical**

Weight 82 g (2.9 oz)

Enclosure Material Polycarbonate, glass

Mount Material Aluminum alloy

Mounting In-wall, gang box (Included)  
Junction box (Optional)

^ **Hardware**

Indoor and Outdoor Use Yes

Ambient Operating Temperature -30 to 45° C  
(-22 to 113° F)

Ambient Operating Humidity 5 to 90% noncondensing

Networking Interface (1) 10/100 MbE RJ45 port

Connectivity BLE 4.1  
NFC

Power Method PoE  
UL 294 Power-limited Class 2 PSU  
UL 60950-1/62368-1 LPS/PS2 PSU

Max. Power Consumption 5W

Supported Voltage Range 48V DC

ESD/EMP Protection Air: ±15kV, contact: ±8kV

Sensors Proximity sensor

Speaker ✓

LEDs R/G/B/W [Learn More](#)

Button (1) Factory-reset

NFC Frequency 13.56 MHz

NFC Read Range < 30 mm (1.18")

NFC Technology	ISO/IEC 14443A / 14443B / 15693 / 18092 (Ecma 340) MIFARE Classic / MIFARE DESFIRE Sony FeliCa™ (ID only) NFC Forum tags T1T, T2T, T3T, T4T and T5T ECP 2.0
PoE Cabling Requirements	Cat 5e cabling is the minimum performance category recommended. The performance category utilized should match the transmission speed required at the installation site. The minimal conductor gauge permitted to connect between the PSE or power injector and the PD shall be 26 AWG (0.13 mm <sup>2</sup> ) for patch cords; 24 AWG (0.21 mm <sup>2</sup> ) for horizontal or riser cable.
UL 294 Statement	Compliance with IEEE 802.3 specifications was not verified as part of UL 294. The equipment is intended to comply with the section of the National Electrical Code, ANSI/NFPA 70, Article 725.121, Power Sources for Class 2 and Class 3 Circuits.
CAN/ULC-60839-11-1 Grade	Grade assignment: I
Certifications	CE, FCC, IC, UL 294, CAN/ULC-60839-11-1
Document number, and issue date and/or revision level	UA-G3, V01
<b>Software</b>	
Management Application	Access
Software Information	The software version can be checked at <a href="https://unifi.ui.com">https://unifi.ui.com</a>

Stay in Touch

Email



Subscribe



